



10x20 LIGHTBOX rental kit to include:

230"w x 92"h lightbox for mural backwall

(1) "EV2" locking standalone counter, 46"w x 20"d black laminate top

(1) Angled accent panels in white, printed or brushed aluminum

(1) "Box" workstation with black laminate top and built in monitor mount

accommodates up to 46" w monitor. Height is not adjustable, position may vary based on your model

CHOICE of black, white, or gray sintra provided standard for all solid infill walls that do not have graphics, unless described otherwise

\*White laminate standard for EV2 wall counter sides and standalone counter front and sides

Consult your account rep for options. Additional elements, merchandising and graphics are available

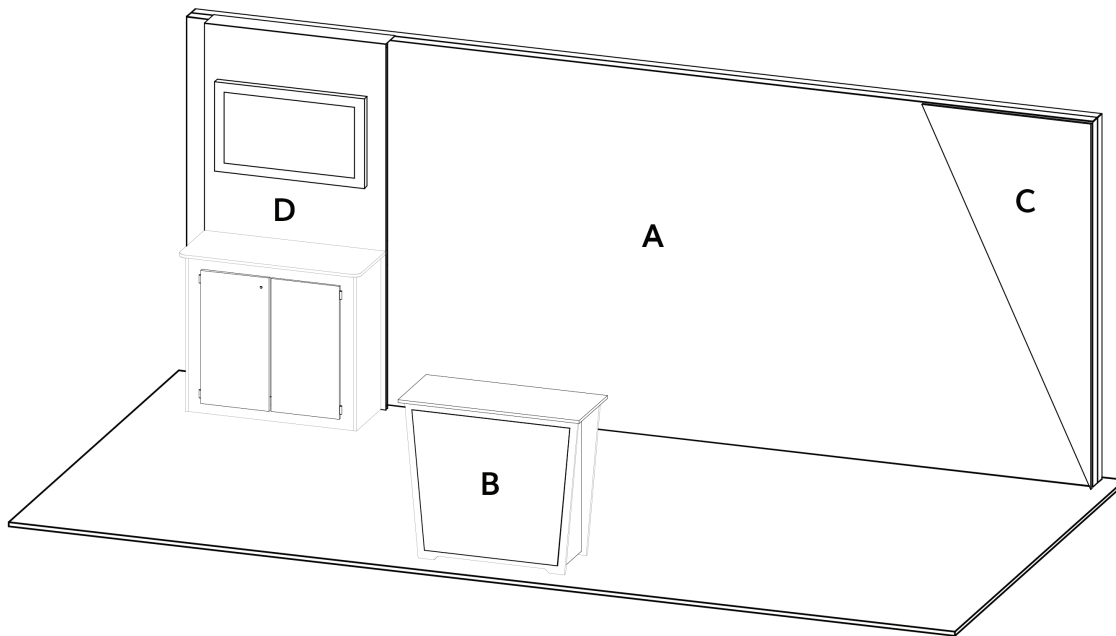

GRAPHICS PACKAGE A TO INCLUDE

A. - (1) 230"w x 92"h fabric graphic required

B. - (1) 40"w x 35"h maximum size, SINGLE USE "low-tac" adhesive, front. Refer to template provided.

White laminate will be visible 2" at the edges or behind any smaller profile cut graphics. (Vector art/cut lines must be provided for profile.)

GRAPHICS PACKAGE B TO INCLUDE

Package A, PLUS

C. - (1) 44.875" w x 92" h printed sintra panel

GRAPHICS PACKAGE C TO INCLUDE

Package A & B, PLUS

D. - (1) 46" w x 92" h printed sintra panel

**KIT PACKAGE PRICING DOES NOT INCLUDE chairs, benches, tables, computers, monitors/cables, and carpet. Additional elements, merchandising and graphics are available through your account representative.**

**Please follow our graphic file submission guidelines for all printed elements to avoid resubmission requests and delay. Allow at least 10 business days for graphic production.**

**Nuheat**



# THE COMFORT YOU DESERVE

Finding the right floor heating system has never been easier.  
We offer a full range of electric radiant floor heating systems  
for any type of room or flooring.

STANDARD AND CUSTOM MATS  
CABLE AND UNCOUPLING MEMBRANE SYSTEM  
MESH

**Nuheat**

# Nuheat



## THE COMFORT YOU DESERVE

Finding the right floor heating system has never been easier. For a full range of electric radiant floor heating systems for any type of room or flooring.

STANDARD AND CUSTOM MATS  
SEPARATE AND UNCOUPLING MEMBRANE SYSTEM

# Nuheat

Nuheat



# THE COMFORT YOU DESERVE

Finding the right floor heating system has never been easier.  
We offer a full range of electric radiant floor heating systems  
for any type of room or flooring.

STANDARD AND CUSTOM MATS  
CABLE AND MATS FOR CONCRETE  
MESH

Nuheat

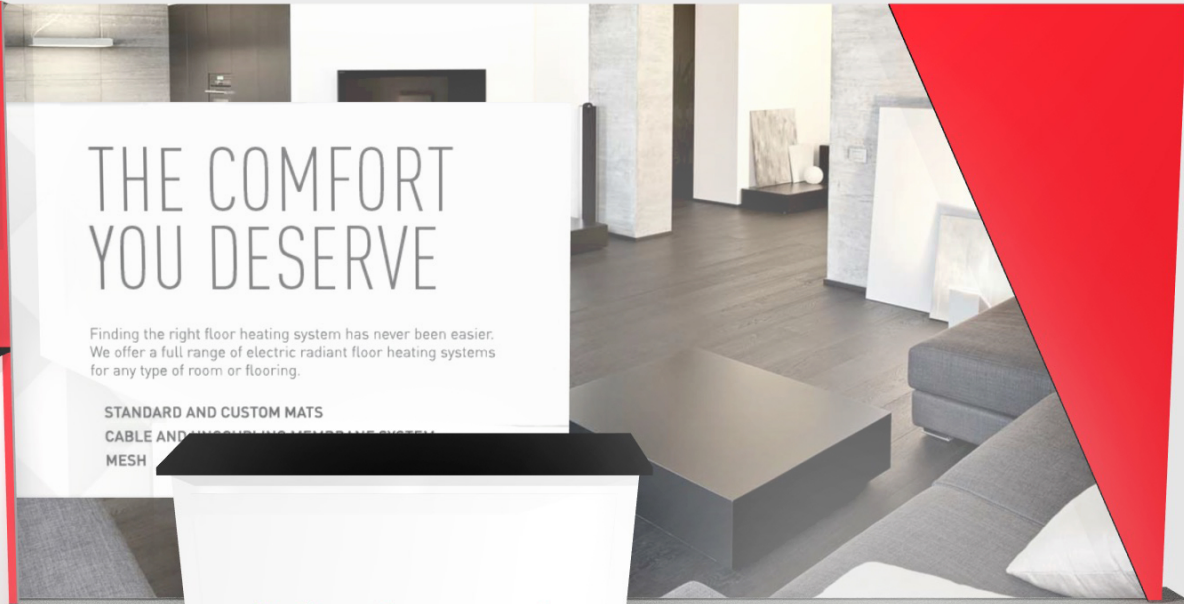

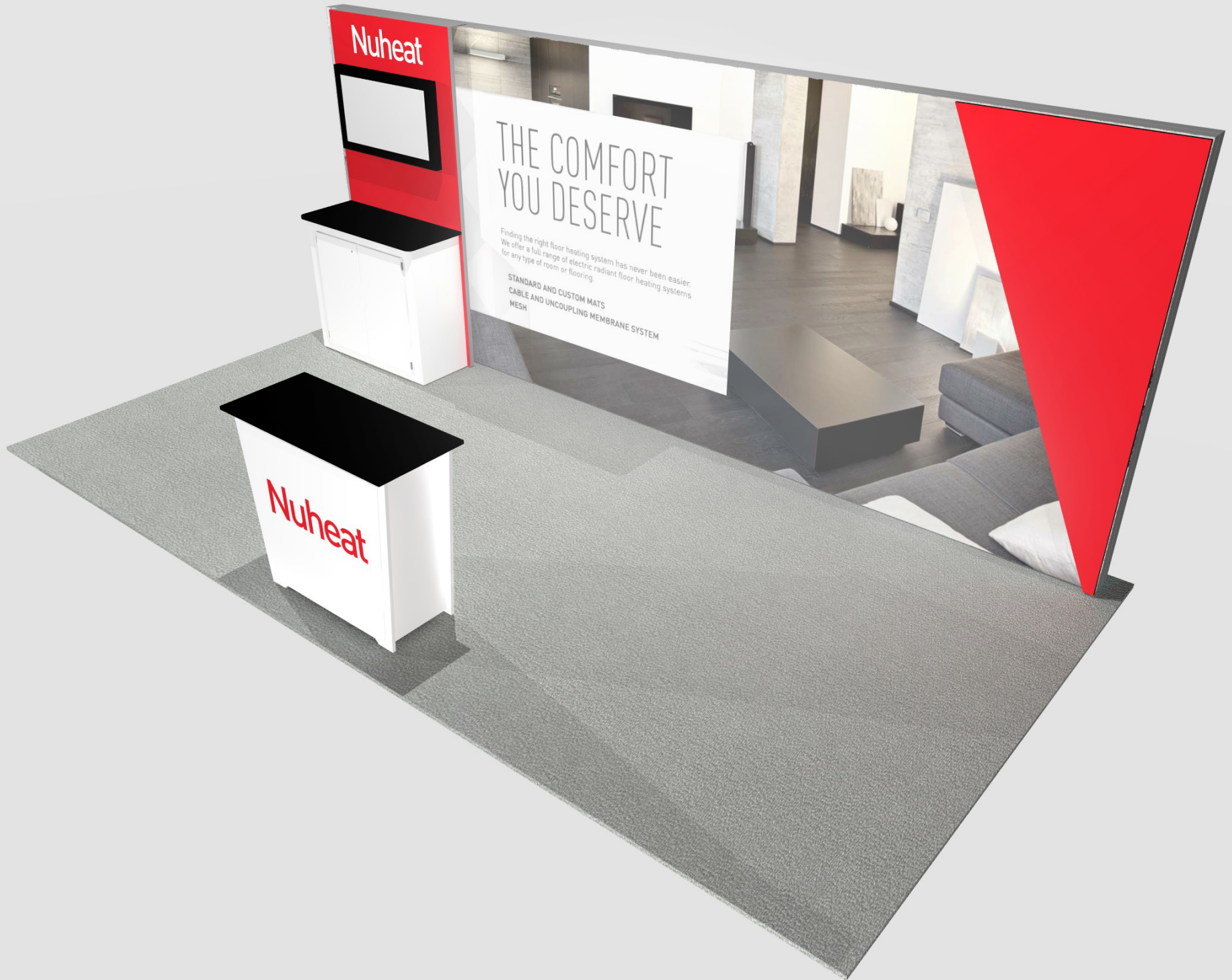

Nuheat

# THE COMFORT YOU DESERVE

Finding the right floor heating system has never been easier. We offer a full range of electric radiant floor heating systems for any type of room or flooring.

- STANDARD AND CUSTOM MATS
- CABLE AND UNCOUPLING MEMBRANE SYSTEM
- MESH

Nuheat

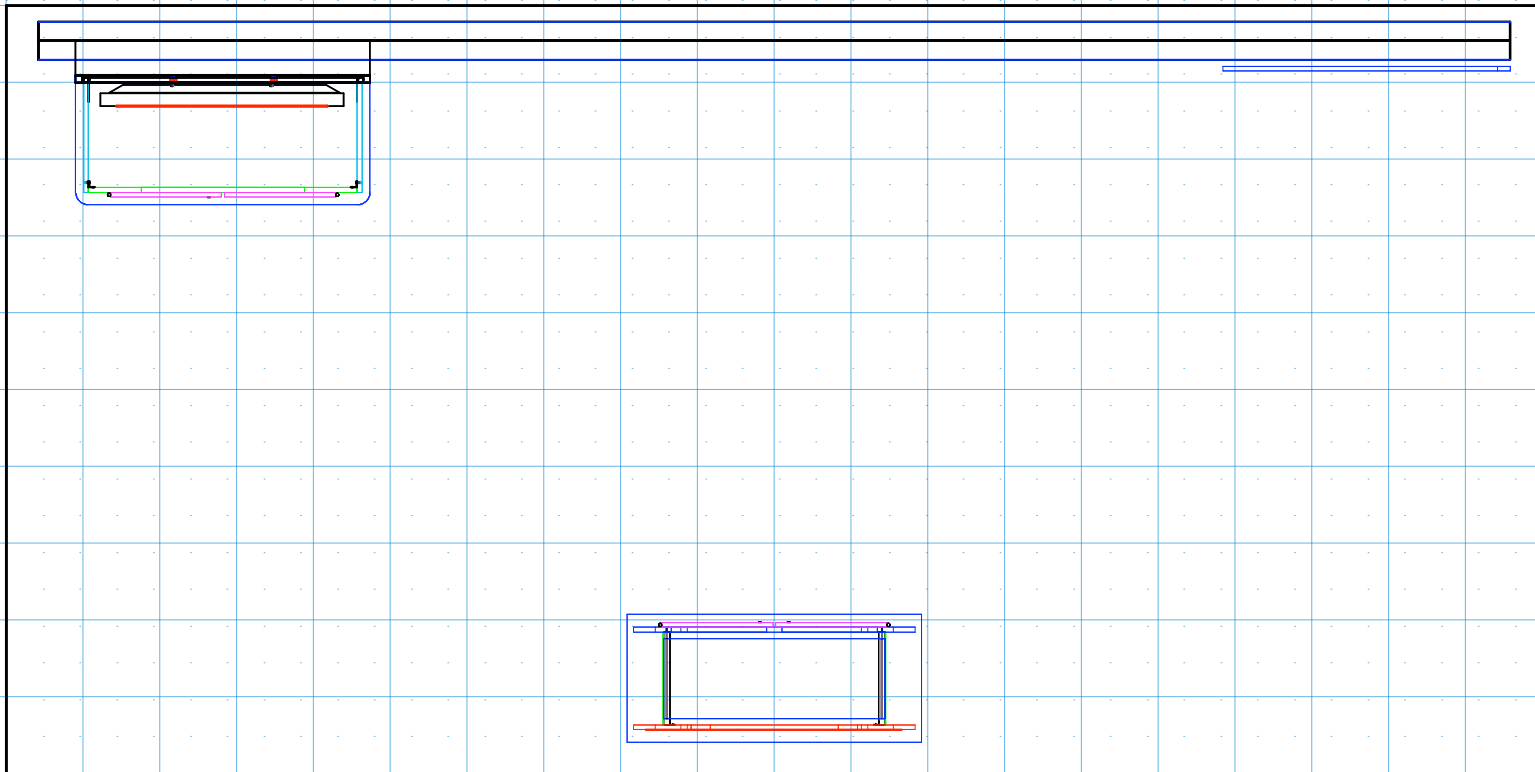

DRAWN BY: LH

**DESIGN : V8 10x20**

**DATE:** 03/17/20

**REFERENCE:** 10X20

**© 2020**

The designs shown herein are protected by copyright and other laws. This document is to be maintained in confidence. No portion of the information or design shown herein may be reproduced, electronically or otherwise, nor may any display be made from this design without written consent.

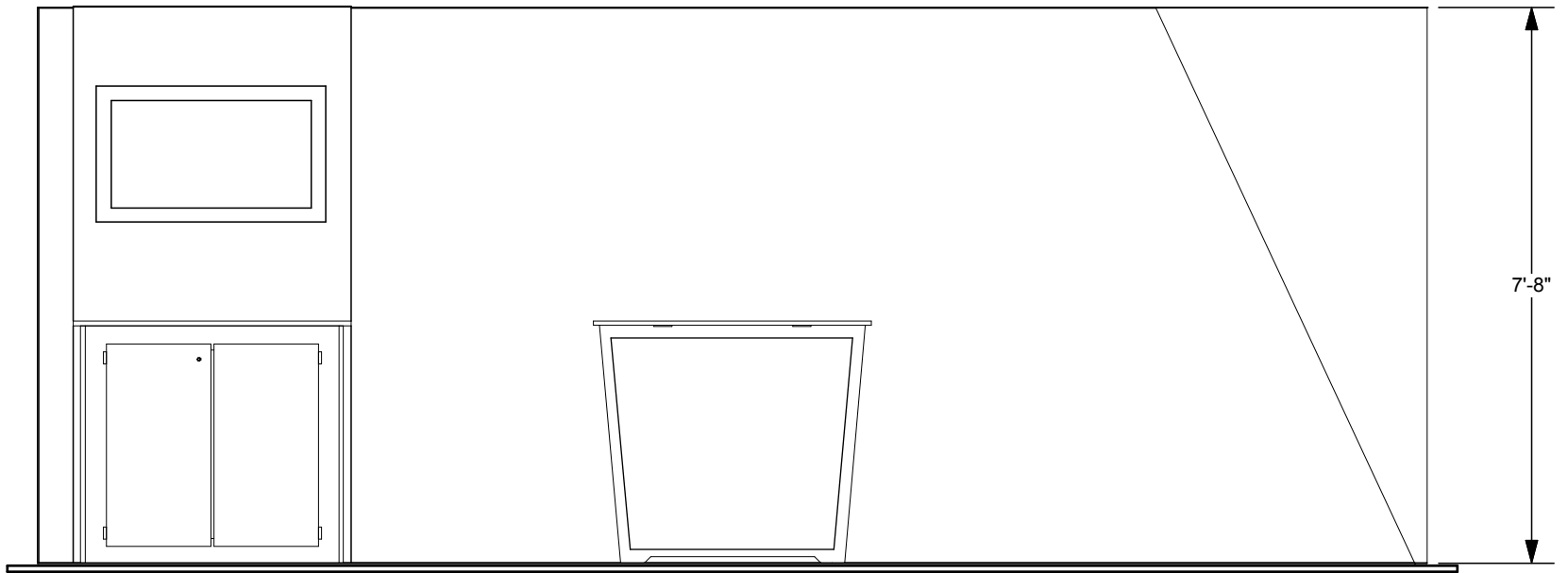

DRAWN BY: LH

**DESIGN : V8 10x20**

**DATE:** 03/17/20

**REFERENCE:** 10X20

© 2020

The designs shown herein are protected by copyright and other laws. This document is to be maintained in confidence. No portion of the information or design shown herein may be reproduced, electronically or otherwise, nor may any display be made from this design without written consent.